

JABRA WAVE

Bluetooth<sup>®</sup> Headset

Works with any Bluetooth<sup>®</sup> enabled phone

DATASHEET



## All-day comfort and wind-noise reduction

Sitting closely and lightly behind your ear, the Jabra WAVE Bluetooth<sup>®</sup> headset prevents wind and background noise from interfering with your conversations. And with its carefully placed mic and DSP technology, the sound quality is always crystal clear. When you wear the Jabra WAVE, you hear every word.

The Jabra WAVE is slim and exceptionally comfortable. A new more advanced version of the classic behind-the-ear style, it can be worn with ease all day long. If at any point the connection with your mobile is interrupted, the headset will simply tell you so via Voice Guidance. It will also inform you if it is soon time to recharge. The Jabra WAVE makes sure you never miss an opportunity. Wear it to work, on the move or in the car.



## Reasons to choose the Jabra WAVE

- Behind-the-ear style for all day comfort
- Spoken battery and connection status
- Connect to 2 Bluetooth devices simultaneously

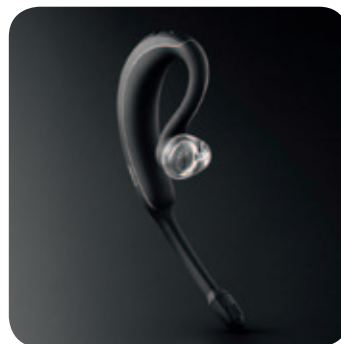

A BRAND BY



JABRA<sup>®</sup> IS A REGISTERED TRADEMARK OF GN NETCOM A/S

[WWW.JABRA.COM/WAVE](http://WWW.JABRA.COM/WAVE)



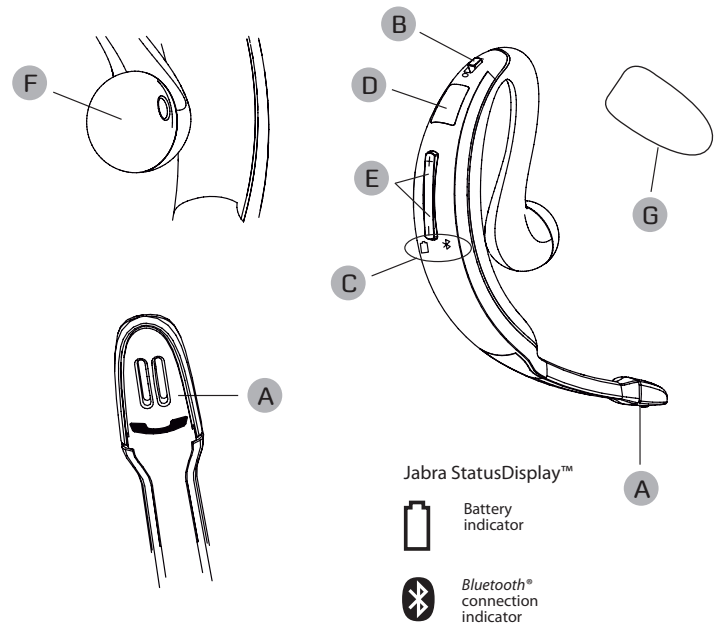

**A Answer/end button**

**B On/off slider button**

**C StatusDisplay™**  
Shows battery and connection status

**D Charging socket**

**E Volume up/down**

**F Jabra Comfort Eargel™**

**G Wind sock**

## Quick Start Guide

### Charge your headset

While charging the headset, the battery indicator will show solid red. When the headset is charged, the battery indicator will turn solid green and turn off after 5 minutes. Charging time is approximately 3 hours.

### Turning your headset on and off

Slide the "on/off" button to turn the headset on or off. If on, the StatusDisplay™ will light up.

### Pairing the headset with your phone

First time pairing: When you turn on your Jabra WAVE for the first time, the headset will automatically start up in pairing mode and show a flashing blue light. For later pairing turn your headset on, press and hold the answer/end button until Bluetooth indicator flashes blue. Activate Bluetooth on the phone and set your phone to search for Bluetooth devices and select Jabra WAVE. Press 'Yes' or 'OK' on the phone and if asked for a PIN code confirm with PIN code 0000 (4 zeros).

### Voice Guidance

#### Connection Voice Guidance

When your headset has successfully established connection with your phone and is ready to be used, the Jabra Voice Guidance will say "connected".

#### Battery Low Voice Guidance

When your headset has battery for less than 30 minutes the Jabra Voice Guidance will say "low battery". This message will be repeated with a ten minute interval.

### Using your headset

Answer a call – Tap the answer/end button on your headset.  
End a call – Tap the answer/end button to end an active call.  
For extra windy situations Jabra supplies a wind sock that even further improves the wind noise reduction.

### Wearing style

With the Jabra WAVE behind-the-ear wearing style allows you to wear the headset on both ears simply by twisting the eargel to fit left or right ear. The eargel comes in two sizes to ensure a good fit for all.

## Features and Specifications

1. Behind the ear wearing style offers great comfort and discreet look
2. 3 layer wind noise protection ensures quality sound on the go
3. Voice Guidance inform you about connection status and low battery when convenient
4. Crystal clear sound via Digital Signal Processing
5. Up to 6 hours talk time and up to 8 days standby time
6. Lightweight – weighs only 0.45 oz (13g)
7. Wear it with your preferred eargel size. Two sizes are provided for individual comfort
8. L 3.9 x H 1.8 x T 0.5 in (L 100 x H 45 x T 12 mm)
9. Bluetooth technology - clear sound with Bluetooth 2.1 + EDR & eSCO
10. First time pairing is automatic to ensure ease of use
11. Features multiuse, answer/end, redial and voice dialling\*
12. Charging plug: USB Micro-B, 5-pin

\* Phone dependent

A BRAND BY

**GN Netcom**

JABRA® IS A REGISTERED TRADEMARK OF GN NETCOM A/S

WWW.JABRA.COM/WAVE

**Bluetooth**